

Glamox Electric (UK) Ltd.
5 College Street Mews
Northampton NN1 2QF
United Kingdom
Phone: +44 1604 63 56 11
Fax: +44 1604 63 01 31
www.glamox.co.uk

AS Glamox HE
Paldiski mnt 35
EE-76606 Keila
EESTI VABARIIK
Phone: +372 6 712 300
Fax: +372 6 712 325
www.glamox.ee

Glamox Ireland Ltd.
Unit D2, Riverview Business Park
Nangor Road
Dublin 12
Ireland
Phone: +353 1 4500 755
Fax: +353 1 4500 688
www.glamox.ie

G grupa SIA
Kr: Valdemara 38-504
1010 Riga
LATVIA
Tel.: +371 7 29 30 20
www.ggrupa.lv

Framaz N.V.
Oudestraat 10
2630 Aartselaar
BELGIUM
Tel.: +32 3 870 9690
www.framaz.be

Apro Lux spol. s.r.o.
Plovdivska 3426/7
143 00 Praha 4
CZECH REPUBLIC
Tel.: +420 244 400 400
www.aprolux.cz

Lisys Lighting Systems Co.
Kassak Lajos U, 81
1134 Budapest
HUNGARY
Tel.: +36 1359 9841
www.lisys.hu

Reykjafell Ltd
Skiptolti 35
125 Reykjavik
ICELAND
Tel.: +354 588 6010
www.reykjafell.is

Prolux S.R.O.
Odborarska 41
831 06 Bratislava
SLOVAKIA
Tel.: +421 2 4564 1245/6
www.prolux.sk

Bell Licht B.V.
Torenstraat 59
3281 XN Numansdorp
THE NETHERLANDS
Tel.: +31 186 653 111
www.belllicht.nl

Gaudre
Ateities 10
08303 Vilnius
LITHUANIA
Tel.: +370 5 279 6162
www.gaudre.lt

Russia
Yakornaja str. 11
St. Petersburg 195027
RUSSIA
Tel.: +7 812 227 38 30

Lampol Group Sp z o.o.
ul. Jad' wingów 22A
02 - 692 Warszawa
POLAND
Tel.: +48 22 853 81 92/3
www.lampolgroup.pl

OR-Lugano (2003) Ltd
P.O. B 1032
KFAR-SABA
44110
ISRAEL
Tel.: +972 974 80 304

Diwan United Trad. & Cont. Co.
P.O. Box 1571
22016 Salmiya
KUWAIT
Tel.: +965 565 0964

Cinmar Lighting Systems LLC
P.O. Box 50007
Dubai
UAE
Tel.: +971 429 599 30

Afoi Yiannopouloi E.p.e.
23 Agias Lavras
16672 Vari
Athens, GREECE
Tel.: +30 210 8972222



ZAPP AQUA

BK999275

GLAMOX LIGHTING SOLUTIONS



We provide you with solutions

Zapp Aqua is a slim and smart IP66 fitting for mounting to wall or ceiling. The design with a Zapp decorative ring gives a decorative background illumination. The fitting comes in white or anodised aluminium. An IP55 version with a daylight and presence detector is also available. Zapp Aqua is made out of long lasting materials like seawater resistant aluminium, galvanised steel and fixings in stainless steel.



INDEX

ZAPP AQUA	page 2
ZAPP AQUA 360	page 3
ZAPP AQUA 465	page 4

ZAPP AQUA - watertight design luminaire



Design

The wide selection of luminaires in the Høvik Zapp product range are with the Zapp Aqua extended to environments where a higher IP range is demanded. This creates a complete lighting design through the whole project.

Sensor

To save energy is more important than ever. Versions with an integrated presence and daylight sensor make this happen, which switches off when there is sufficient light or no people in the area.

Solid

The design where materials like seawater resistant aluminium together with galvanised steel and stainless steel fixings will help to avoid problems with corrosion.

ZAPP AQUA 360



- Slim and elegant IP66 ceiling/wall luminaire with decorative backlighting.
- Available with Sensor (combined presence detector and light sensor), IP55.
- Can be used in places such as public wet areas, outdoor entrances etc.
- House number or name sign available in three sizes.



Name/number sign



ZAPP AQUA sensor

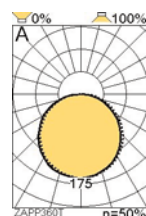

Specifications

Luminaire body with a 3mm thick decor ring made of white painted or anodised marine corrosion resistant aluminium. Impact resistant opal acrylic diffuser. Assembly backplate made in galvanized white painted steel. Screws in stainless steel. Available with combined presence detector and light sensor mounted in the centre of the diffuser (IP55). The sensor can be set to user defined values:
 Delay time: 5secs to 30min
 Bright out light value: OFF, 50 - 2.000lux
 Factory settings: "Delay time" - 15min, "Bright out light value" - OFF. House number or name sign available in three different sizes. All the internal wiring is double insulated. IP55/66, class I.



Light source

Zapp Aqua 360 is available in 1-tube T5C 22W.

Ballast

Zapp Aqua 360 is available with electronic ballast (HF) only.

Mounting

Surface mounted luminaire for installation on the wall or ceiling by use of a centre bracket.

Connection

2.5 mm² 5-way push-in terminal block ready for through wiring.

IP55/66, Ta=25°C

Type	Code no			Weight kg	Lamp ZVEI	Base	Photo metric
	HF	HF PIR	HFDd				
ZAPP AQUA 360 122 NA	267080	267081	267085	1.4	T16-R	2GX13	A
ZAPP AQUA 360 122 WH	267180	267181	267185	1.4	T16-R	2GX13	A
Accessories							
ZAPP AQUA 360 SIGN MAXI NA	267090						
ZAPP AQUA 360 SIGN MAXI WH	267190						
ZAPP AQUA 360 SIGN MIDI NA	267091						
ZAPP AQUA 360 SIGN MIDI WH	267191						
ZAPP AQUA 360 SIGN MINI NA	267092						
ZAPP AQUA 360 SIGN MINI WH	267192						

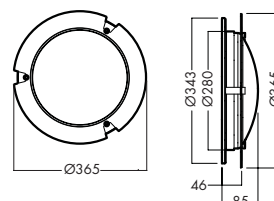

ZAPP AQUA 465



- Slim and elegant IP66 ceiling/wall luminaire with decorative backlighting
- Available with Sensor (combined presence detector and light Sensor), IP55
- Can be used in places such as public wet areas, outdoor entrances etc.



ZAPP AQUA ceiling



ZAPP AQUA sensor

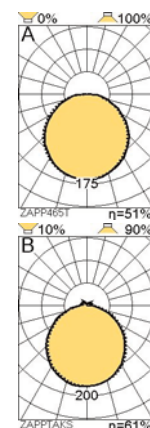

Specifications

Luminaire body with a 3mm thick decor ring made of white painted or anodised marine corrosion resistant aluminium. Impact resistant opal acrylic diffuser. Assembly backplate made in galvanized white painted steel. Screws in stainless steel. Available with combined presence detector and light sensor mounted in the centre of the diffuser (IP55). The sensor can be set to user defined values:
 Delay time: 5secs to 30min
 Bright out light value: OFF, 50 - 2.000lux
 Factory Settings: "Delay time" - 15min, "Bright out light value" - OFF.
 All the internal wiring is double insulated. IP55/66, class I.



Light source

Zapp Aqua 465 is available in 1-tube T5C 40 or 55W.

Ballast

Zapp Aqua 465 is available with electronic ballast (HF) only.

Mounting

Surface mounted luminaire for installation on the wall or ceiling by use of a centre bracket.

Connection

2.5 mm² 5-way push-in terminal block ready for through wiring.

IP55/66, Ta=25°C

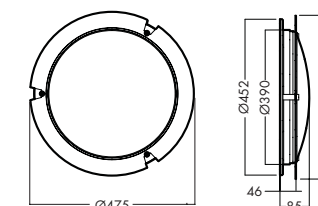

Type	Code no			Weight kg	Lamp ZVEI	Base	Photo metric
	HF	HF PIR	HFDd				
ZAPP AQUA 465 140 NA	266081	266083	266086	2.2	T16-R	2GX13	A
ZAPP AQUA 465 140 WH	266181	266183	266186	2.2	T16-R	2GX13	A
ZAPP AQUA 465 155 NA	266080	266082	266085	2.2	T16-R	2GX13	B
ZAPP AQUA 465 155 WH	266180	266182	266185	2.2	T16-R	2GX13	B



ZAPP 360/465 ZAPP sign ZAPP pendant ZAPP tube



ZAPP 360/465 ZAPP sign ZAPP pendant ZAPP tube